

Avela Outdoor**OD843_ 1.0****GENERAL PRODUCT INFORMATION:**

This product can mount to either a 4" square electrical box with round plaster ring or an octagon electrical box.

This product is suitable for wet locations.

This product may be dimmed with a low-voltage electronic dimmer.

**CAUTION - RISK OF FIRE**

This product must be installed in accordance with the applicable installation code by a person familiar with the construction and operation of the product and the hazards involved.

Use minimum 90°C supply conductors.

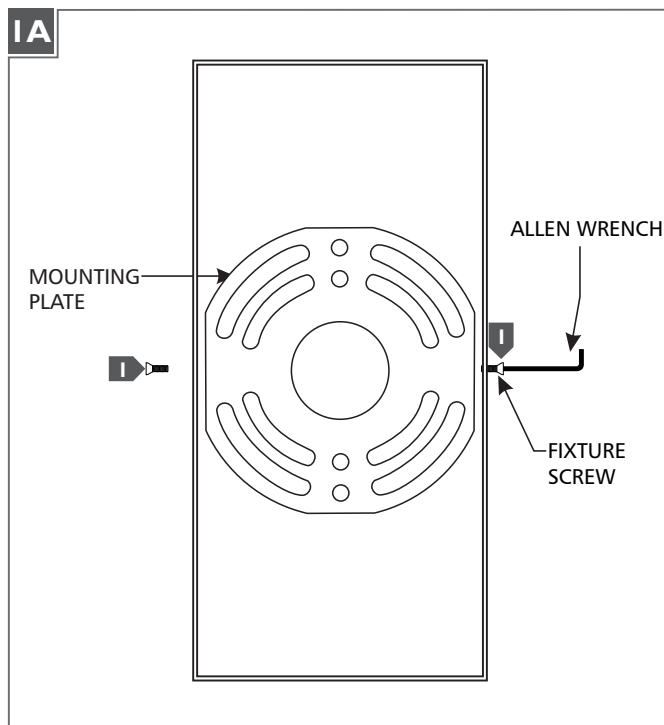
Install the Driver and Mounting Plate

1 With the Allen wrench provided, remove the two fixture screws.

2 Remove the mounting plate from the back of the fixture.

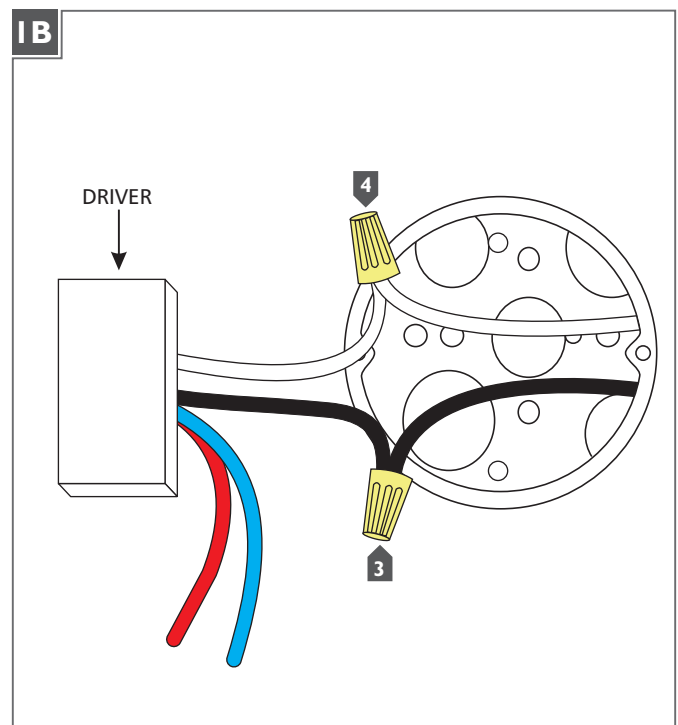

3 Connect the black driver wire to the hot power line wire with a wire nut.

4 Connect the white driver wire to the neutral power line wire with a wire nut.

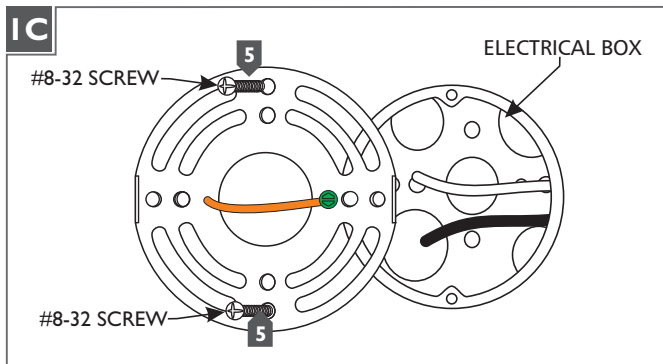

- 5** Properly place the driver and the wire nut connections into the fixture base, leaving the black and white driver wire accessible.
- 6** Install the mounting plate onto the electrical box with the two #8-32 screws provided.

Install the Shade

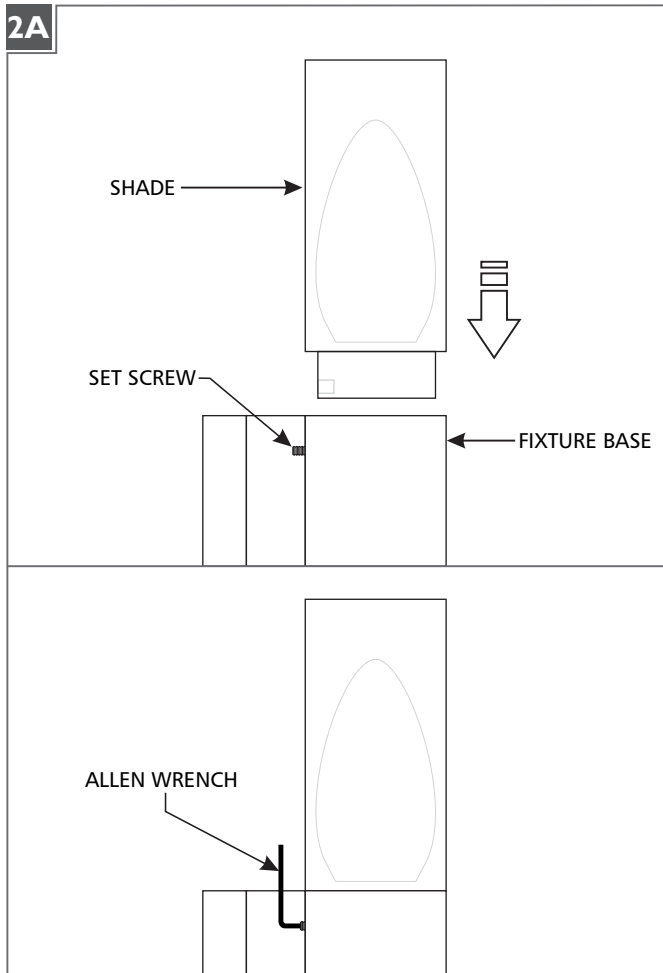

- 1** Ensure that the set screws for the shade are backed out (**DO NOT REMOVE**) and insert the shade into the fixture base.
- 2** Secure the shade by tightening the set screws with the provided Allen wrench.

Install the Fixture

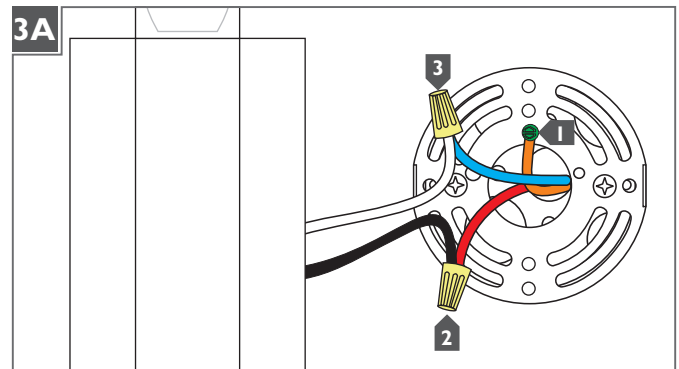

- 1** Connect the mounting plate ground wire to a suitable ground in accordance with local electrical codes.
- 2** Connect the black fixture wire to the red driver wire with a wire nut.
- 3** Connect the white fixture wire to the blue driver wire with a wire nut.
- 4** Properly place the wires and wire nut connections into the electrical box.
- 5** Mount the fixture by sliding it back onto the mounting plate and reinstalling the fixture screws (reversal of figure 1A).

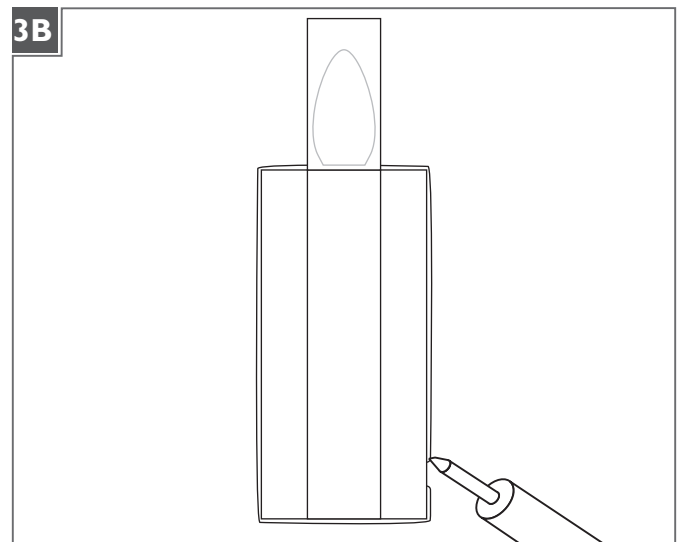

- 6** For wet locations, caulk around the base with waterproof construction sealant.

SAVE THESE INSTRUCTIONS!

LBL

7400 Linder Ave, Skokie, IL 60077
800.323.3226 - 847.626.6300

www.lblighting.com

© 2015 LBL Lighting. All rights reserved. The "LBL Lighting" graphic is a registered trademark of LBL Lighting. LBL Lighting reserves the right to change specifications for product improvements without notification.
A Generation Brands Company