

**360°**  
BENDING  
LED NEON FLEX

FLEX-MOUL-S2323

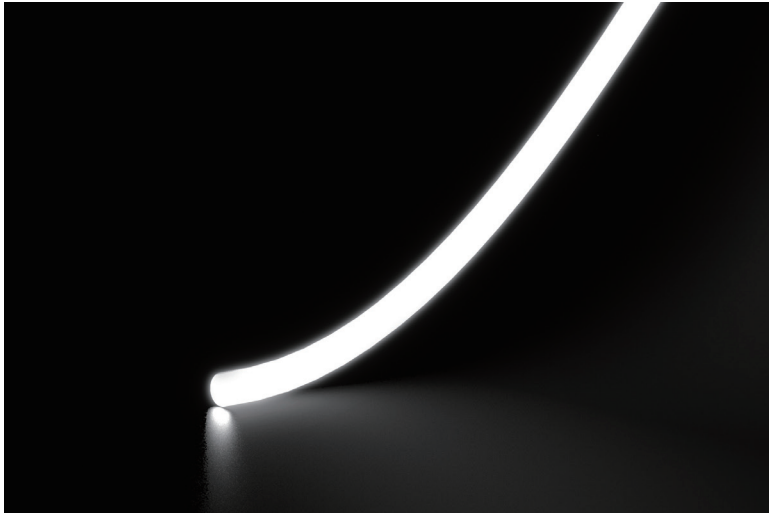



**Features**

- Color options: Single color.
- Design: Superior design with exquisite craftsmanship ensure stable and reliable performance.
- Flexibility: 360 bending, min. bend diameter 120mm [4.72inch].
- IP grade: Silicone extrusion, IP65 protection.
- Warranty: 5 years indoor, 3 years outdoor.
- Customization: multiple spec options, can be customized upon requirements.



**Optical & Electrical Parameters**

Model No.	FLEX-MOUL-S2323					
CCT/Wavelength (K/nm)	2400K	2700K	3000K	4000K	5000K	6500K
Beam Angle (°)	360	360	360	360	360	360
Luminous Flux (lm/m)	1156	1270	1457	1466	1473	1362
CRI	70+	70+	70+	70+	70+	70+
Efficacy (lm/W)	71.6	84.3	90.3	90.5	92.8	85.1
Voltage (V DC)	24	24	24	24	24	24
Measured Power (W/m)	16.0±10%	16.0±10%	16.0±10%	16.0±10%	16.0±10%	16.0±10%

Model No.	FLEX-MOUL-S2323				
CCT/Wavelength (K/nm)	Red	Green	Blue	Yellow	Orange
Beam Angle (°)	360	360	360	360	360
Luminous Flux (lm/m)	435	1338	315	201	393
CRI	--	--	--	--	--
Efficacy (lm/W)	27.2	83.6	19.7	12.6	24.6
Voltage (V DC)	24	24	24	24	24
Measured Power (W/m)	16.0±10%	16.0±10%	16.0±10%	16.0±10%	16.0±10%

**Other Parameters**

Model No.	FLEX-MOUL-S2323
LED QTY (pcs/m)	336
Product Size L*W*H(mm)	5000*23*23
Standard Run Length(mm)	5000
Min. Cuttable Length(mm)	35.71
Working Temperature	-20~+60°C
Storage Temperature	-20~+70°C

**Note:**

The given data is typical values. Due to tolerances of the production process and the electrical components, values for light output and electrical power can vary up to 10%.

Profile Drawings

Unit:mm[inch]

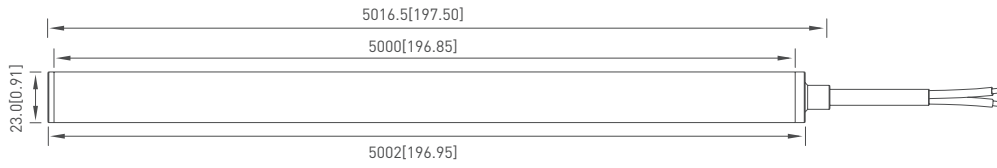

Bend direction

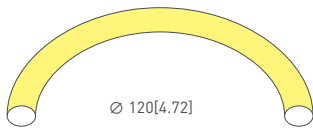

Bending Diameter

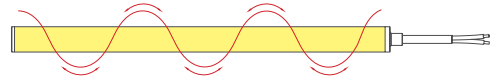

Sectional view

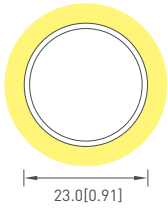

Front cap

Glue Process (IP67)

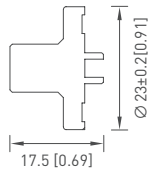

Closing End-cap

Glue Process (IP67)

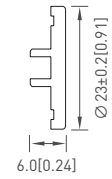

Remarks: "L" is the standard size of the light strip, can be customized according to the multiple of the minimum cutting unit length.

IP Process Technology

Injection Moulded (IP65)

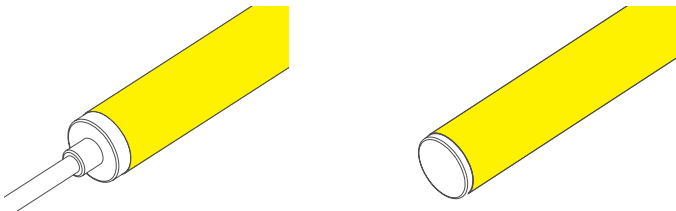

- After cutting, the IP protection of both glue processed and injection moulded product will drop to IP65, for injection moulded product, if customer self-processed injection moulded end cap for the cutted end, the IP protection will keep the IP65 level.
- Injection moulded end cap self-processing, need to prepare corresponding mold and molding equipment.
- If the customer reprocesses Blueview injection moulded end cap, and the waterproof of the molded end does not meet Blueview standard, the potential troubles are not covered by the warranty.

Product accessories



PCIS (front)



ECS (end)

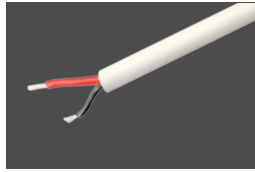

Cable

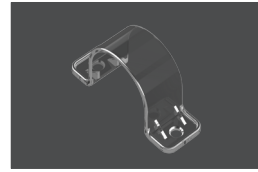

Clips

Installation method

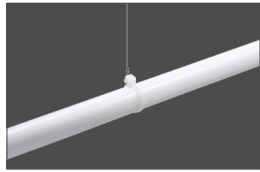

Pendant Rope and ribbon set

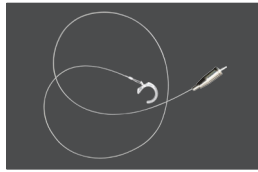

Pendant Rope and hook set

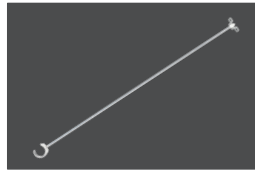

Pendant Pole and hook set

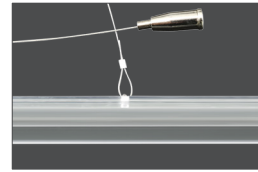

Pendant PC groove set

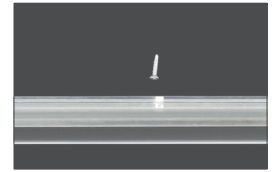

Ceiling PC groove set

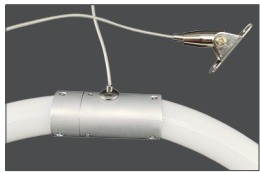

Round splice set

Luminous Intensity Distribution Diagram

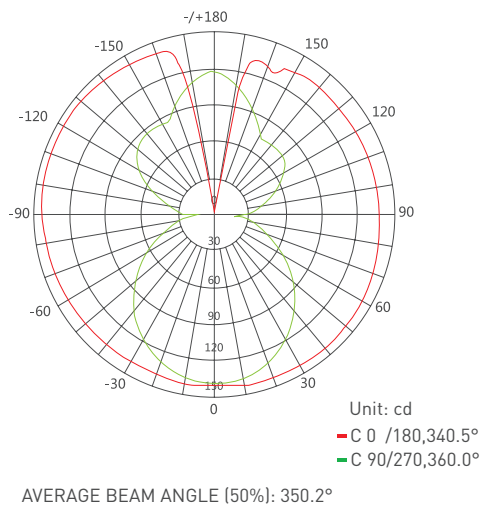

Average Illumination

Flux Out: 238.7lm (CCT=6500K)

Height	Eavg, Emax	Beam Angle: 90.00°	Diameter
0.5m	304.0,636.9lx		100cm
1.0m	76.0,159.2lx		200cm
1.5m	33.8,70.8lx		300cm
2.0m	19.0,39.8lx		400cm
2.5m	12.2,25.5lx		500cm
3.0m	8.44,17.7lx		600cm
3.5m	6.20,13.0lx		700cm
4.0m	4.75,9.95lx		800cm
4.5m	3.75,7.86lx		900cm
5.0m	3.04,6.37lx		1000cm

Note: for other data, please consult sales rep.

### Packaging information

Model No.	FLEX-MOUL-S2323
Product Size L*W*H (mm)	5000*23*23
Carton Size (mm)	480*445*370
Meter/Reel	5
Reel/Carton	6
Net Weight (kg)	--
Gross Weight (kg)	15.35 (1± 10%)

Note: The gross weights of all above model are less than volume weight, the volume weight is 15.81kg

### Recommended power supply upon working length

Model No.	FLEX-MOUL-S2323	
Working Length(m)	1	5
Rated Current (A)	0.67	2.80
Rated Voltage (DC V)	24	24
Rated Power(W)	16	67.2
Recommended Power Supply(W)	25	100
Power Supply Mode	Single Feed	Single Feed



418 907-2585  
info@innovadel.com